

HARBOUR MOSAIC
HELSINKI

HARBOUR MOSAIC HELSINKI

Brings together sustainable design, green architecture, eco solutions, integrating cultural urban layers to the existing historic fabric.

Through a process of urban surgery it is possible to enhance the existing values of the site by preserving the historically relevant and optimizing the public spaces to best suit the needs of the citizens. The paramount attribute of the area is its human scale, therefore the solution, functional routes and connections, distances, urban fixtures and visual corridors were built around the experience of the pedestrian.

The aim of the entire project is to bring together and establish communication between different urban areas of Central Helsinki, which at the moment seem fragmented and tend to prefer a dysfunctional urban monologue. Therefore, the Observatory Hill Park is extended and in direct dialogue with the harbour, the South Harbour is communicating functionally and becomes better connected to the Market Square, while the Esplanadi pedestrian area is continued and articulated by the newly proposed Museum area toward the new Katajanokka commercial, residential and business area. The urban fracture, distinguishable nowadays at an urban level, is mitigated through the choice of pedestrian routes, considering the human scale and through the control over the dominant perspectives toward existing landmarks.

The heights of the buildings, especially in the Katajanokka region considered the visibility corridors toward the main landmarks. The perforated front of buildings toward the port aims to enhance the visibility toward the historic buildings in the background.

Overall, the proposal integrates the natural environment, the historical layers, the cultural significance of the place into one coherent urban continuum that transmits our values and ideals to future generations.



DESCRIPTION

1 TERMINAL, CONGRESS CENTRE AND BUSINESS HOTEL

Underground	parking 180 vehicles
G.F. + entrance	terminal extension 11 200 sqm
2nd floor	congress center 7 000 sqm
3rd floor	business hotel 2 700 sqm

2 RESIDENTIAL BUILDINGS

Underground	parking 418 vehicles
G.F.	commercial 10 400 sqm
Planted Terrace	4000 sqm
1st floor	Housing 6000 sqm + 2000 sqm terrace
2nd floor	Housing 5000 sqm + 2000 sqm terrace
3rd floor	Housing 5000 sqm + 1800 sqm terrace
Penthouse	4000 sqm + 2000 sqm terrace

3 MUSEUM

Underground	parking 180 vehicles
Expo	4000 sqm
Water surface	(skating ring) 2000 sqm
Public square	10000 sqm

4 TRAIN LINE

Katariikka Area is linked with the Historic Market Square through a newly proposed 2 km long train line, which will more than double the existing vegetation along Katariikkantunneli.

5 MARKET SQUARE AREA

Systematisation of Market Square selling area
Walkway to the Museum Plaza
Urban Platform
Pedestrian-bridge link
Historic Market Building + Plaza

6 URBAN FARMING PAVILION

Farming Pavilion	1200 sqm
Outdoor Parking	30 vehicles
Docking Area for	24 small boats
Urban Plaza	2000 sqm
Entry point to covered parking area	

7 PARK

Underground Parking	200 vehicles
Ground floor Commercial area	7000 sqm
Planted Terrace over ground floor	8000 sqm
1st floor Commercial area	8000 sqm
Planted Terrace over 1st floor	8000 sqm
Amphitheatre	1200 sqm
Kids playground	1500 sqm

0 50 100

02
TERMINAL, CONGRESS CENTRE
AND BUSINESS HOTEL

INFO

The underground level houses the building's parking area, the ground floor and entrance are the new terminal, an extension of the existing it should be terminal. The main stories of the building houses the Congress Centre with a direct sea view. The top floor will feature a business hotel, directly linked to the Congress Centre.

URBAN (BOUND)

New Green Belt Line
New Pedestrian Highways
Sea Canal

RESIDENTIAL BUILDINGS

INFO

Focusing on the quality of living and the perspective toward the harbour, the dominant horizontal volume contains three public functions: parking area in the basement, commercial spaces, cafes and restaurants on the main floor and a planted urban slab acting as a natural connecting element between the sea and the city, the public space and the residential volumes. The geometry of residential volumes references the silhouette of the cruise ships while creating a perforated foreground through which the historic fabric can be read.

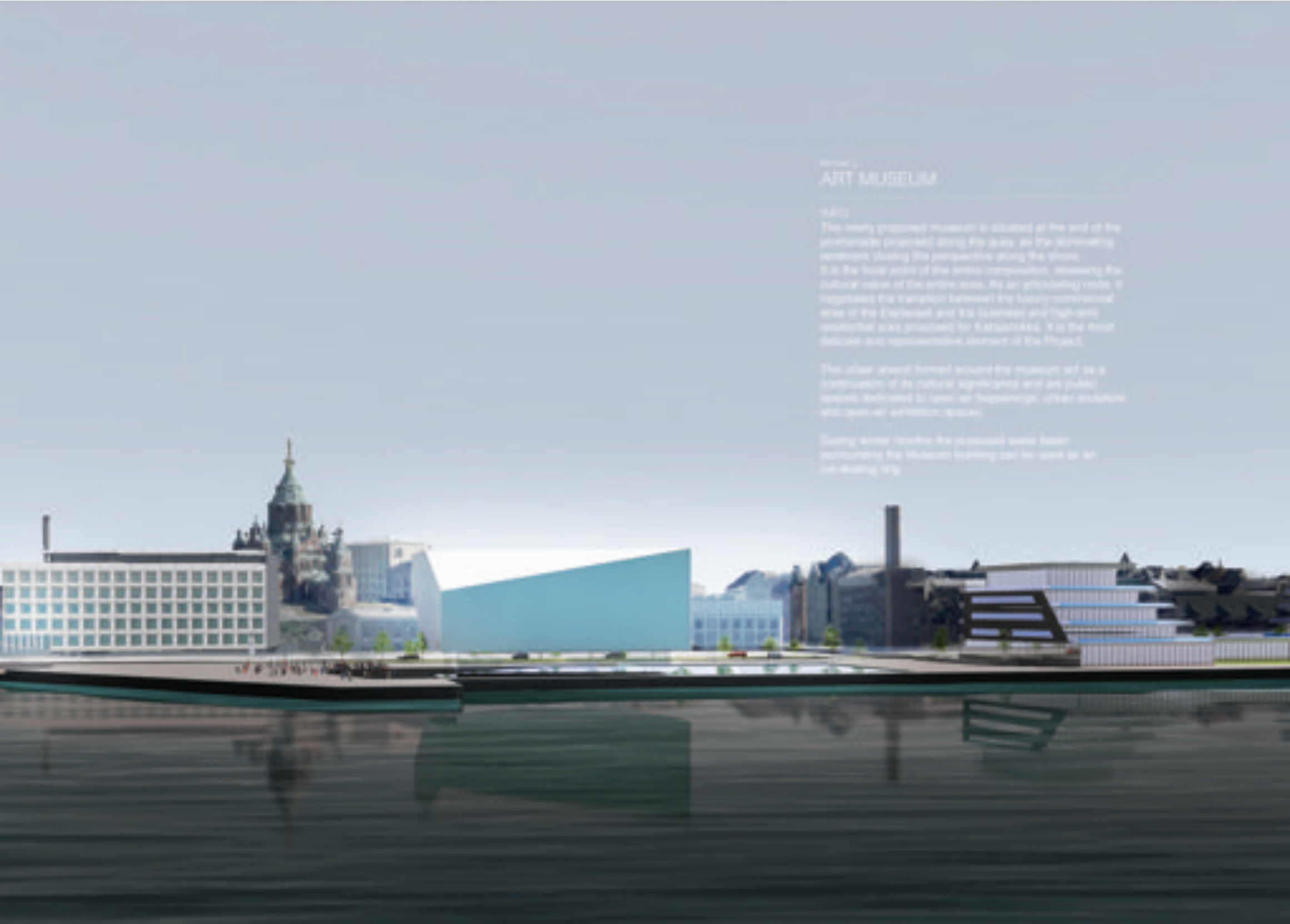

An architectural rendering of a modern art museum complex situated along a waterfront. The scene features a large, multi-story building with a grid of windows on the left, a prominent church with a tall spire in the background, and a large, angular, light-blue structure in the center. To the right, there are several smaller, modern buildings with horizontal slats. The foreground shows a dark, reflective body of water with a small boat. The sky is a clear, light blue.

ART MUSEUM

0401

The newly proposed museum is situated at the end of the promenade (proposed) along the quay, as the remaining landmass closing the perspective along the shore. It is the focal point of the entire composition, showing the cultural value of the entire area. As an activating node, it regulates the transition between the luxury commercial area of the Explorer and the business and high-end residential area proposed for Katsaridika. It is the most delicate and representative element of the Project.

The urban street formed around the museum act as a continuation of its cultural significance and art public spaces designed to open up "loggias", urban sculpture and open-air exhibition spaces.

During winter months the proposed water basin surrounding the Museum building can be used as an ice-skating ring.

An architectural rendering of a public square, Market Square, under a bright blue sky with a sun flare and three birds flying. The square is paved with grey cobblestones and features several rectangular wooden planters with dark metal frames. People are walking and standing throughout the square. In the background, a large, curved, modern bridge spans across a body of water. Buildings and a church spire are visible on the far side of the water.

Area 2 MARKET SQUARE

1470

Acknowledging its value as a representative public space, the project proposes a systematization of the Market Square, highlighting the role of the Presidential Palace, the Supreme Court, the City Hall, and the Swedish Embassy in the present urban layout. The systematization maintains the Market Square as a representative public square and allows the forming of a Urban Platform.

The Covered Market, which is considered an important and recent landmark of the area is protected and combined.

Section 1
PEDESTRIAN BRIDGE

INFO
The physical connection between the Market square and the Covered Historic Market is emphasized by a dynamic pedestrian bridge.

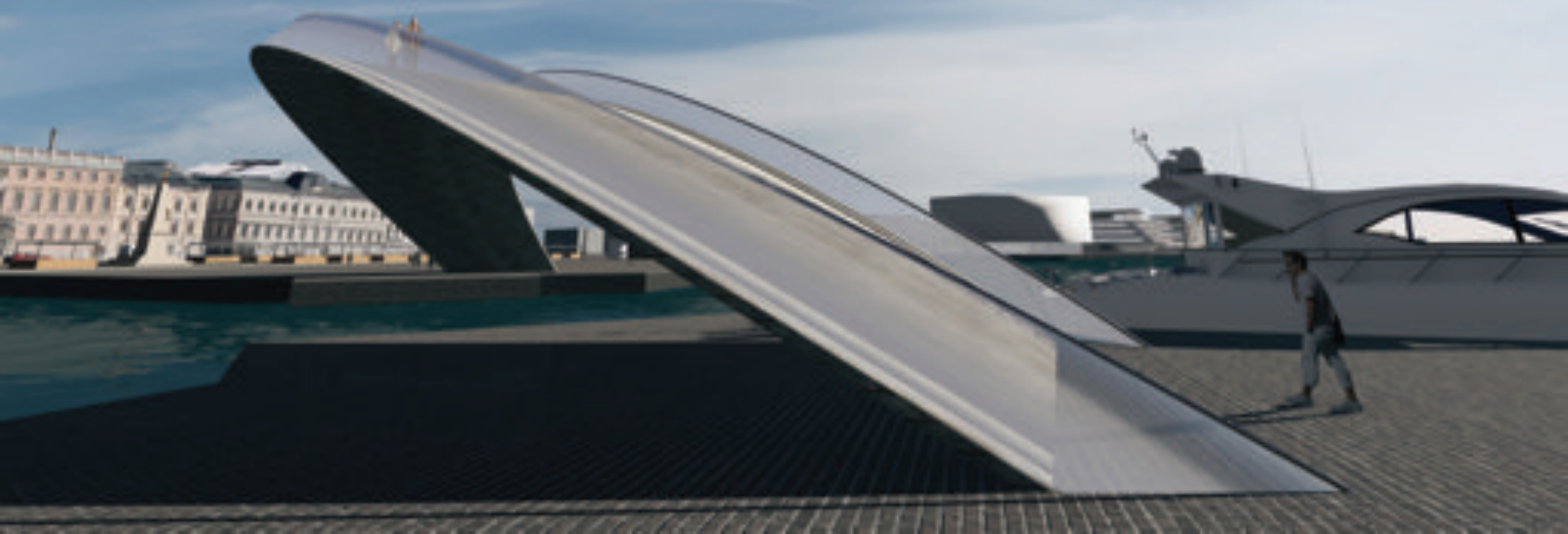

Phase 2

URBAN FARMING PAVILLION

INFO

A 300sqm metal and glass pavilion equipped with hydroponic and aquaponic farming systems is proposed in close vicinity to the Historic Market building. The Farming Pavilion is an urban space that promotes and facilitates the production of food (fruit, herbs, grains and vegetables) in urban environments.

RENDER PRODUCTS

- Pedestrian Waterfront Promenade
- Outdoor Parking



An architectural rendering of a suspended park. The park is a large, green, curved platform with a dark grey border, suspended over a body of water. In the foreground, a large, semi-circular structure with white, curved, ribbed seating and a wooden floor is visible. People are scattered across the green area. In the background, a city skyline is visible across the water under a blue sky with light clouds.

Research

SUSPENDED PARK

INFO

The dominant element proposed for the South Harbour Area, is a Suspended Park - a built, planted element that provides the Observatory Hill Park (Tähtitorninvuorenpuisto) with an extension all the way to the Helsinki Harbour. The existing roads are engulfed by a tunnel within this new element - a mixture of natural environment and man-made structure.

Aiming to maintain the lowest possible carbon footprint by using state-of-the-art green systems, this structure will seamlessly integrate itself into the natural environment, creating a green breathing bridge between the park and the harbour.

Providing a covered parking lot and commercial spaces on the ground level below, the original structure and materials are employed and modern architectural details, artistic lighting elements and a modern character are introduced. At the same time, a clear reference to the historical urban fabric of Central Helsinki is offered to the pedestrian from its greeny platform.

The existing South Terminal is preserved, while a modernization is proposed.

THANK YOU!